



37/9 Verley Drive Homebush NSW

3 🏠 3 🚿 3 🚗

This exceptional townhouse creates a peaceful and sophisticated atmosphere composed of quality finishes. spread over two levels of contemporary living this near new home will accommodate the entire family with 3 large bedrooms, 3 bathrooms and a huge basement, remote control 2 car lock up garage plus storage with internal access, and an extra car spot. Superbly maintained, this home promises immense satisfaction and features quality fixtures. It's conveniently close to DFO and transport, while only 15kms drive from Sydney CBD.

Type : Townhouse
Land Size : 241 sqm
View : <https://www.vassagroup.com.au/lease/nsw/inner-west/homebush/residential/townhouse/7179340>

Lifestyle Location - Walking distance to North Strathfield Station, cafes, Olympic Park, DFO, schools, and parkland.

Features include:

- Spacious living and dining area with timber floor, Air conditioning
- Security Intercom and security alarm system
- Large light filled entertainers courtyard and rear balcony
- Spacious bedrooms with built in robes, main with ensuite
- Granite kitchen with stainless steel gas appliances and

[For full version visit the website](#)



Luce Lv
02 9268 0086

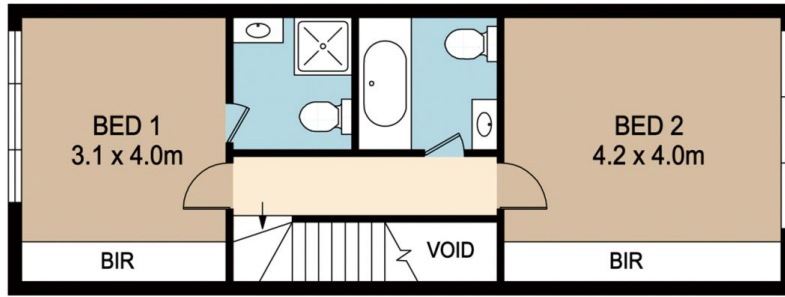

FIRST FLOOR

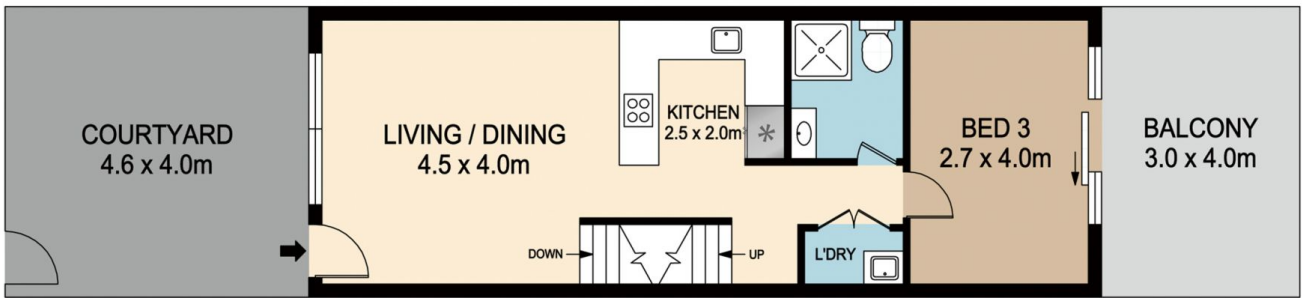

GROUND FLOOR

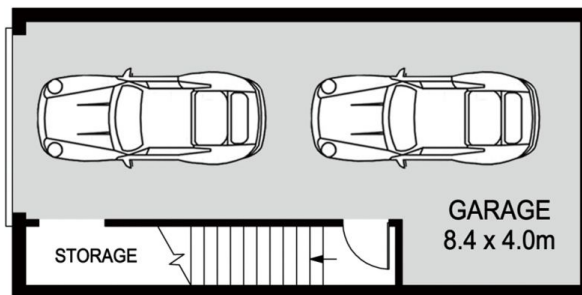
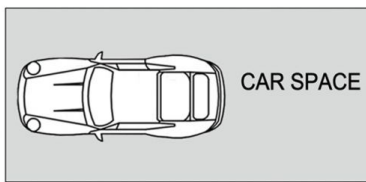

BASEMENT

37/9 VERLEY DRIVE, HOMEBUSH



DISCLAIMER PLANS SHOWN ARE FOR MARKETING PURPOSES ONLY, ALL DIMENSIONS ARE APPROXIMATE AND NOT TO SCALE. THEY ARE SUBJECT TO ERRORS AND INACCURACIES AND NO LIABILITY WILL BE ACCEPTED. INTERESTED PARTIES SHOULD MAKE THEIR OWN INQUIRES.